

AiM Lotus cluster - Installation guide

Remove the indicated original parts.

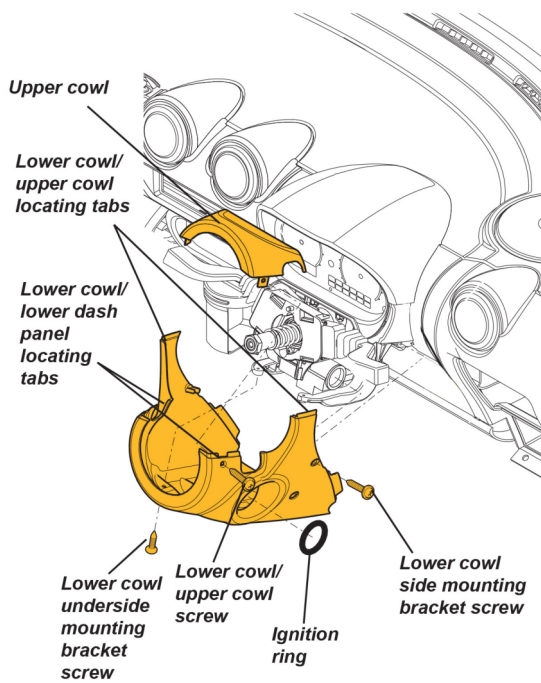

Note: it is not necessary to remove the steering wheel.

Remove the original cluster.

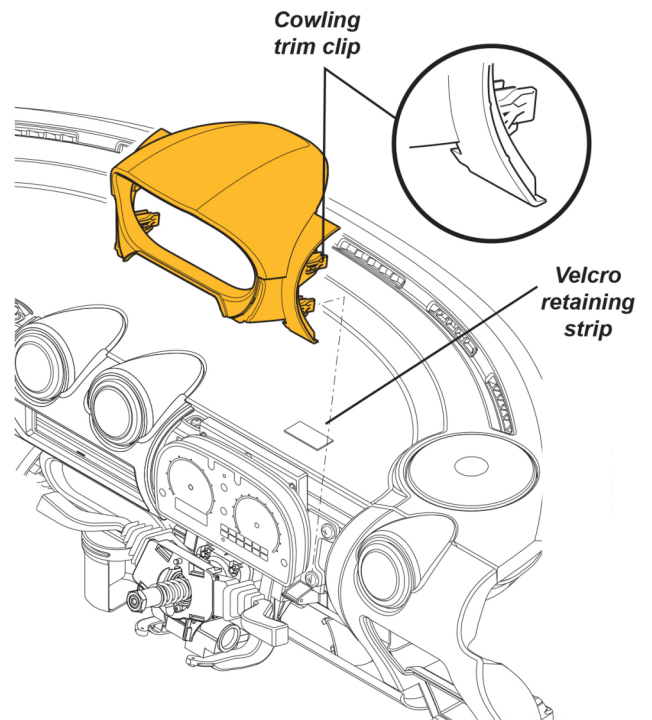

Remove the original dashboard.

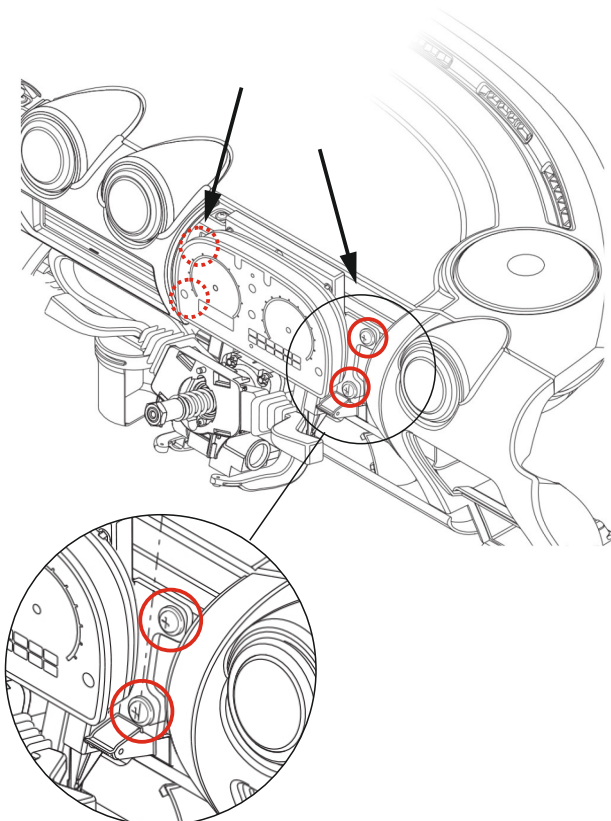

Install the MX2E on the original bracket.

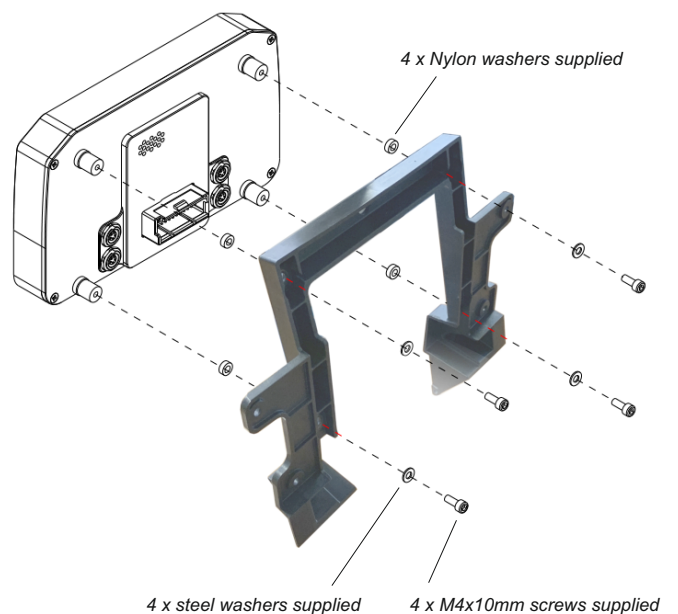

AiM Lotus cluster

Installation guide

Connect MX2E with AiM cluster.

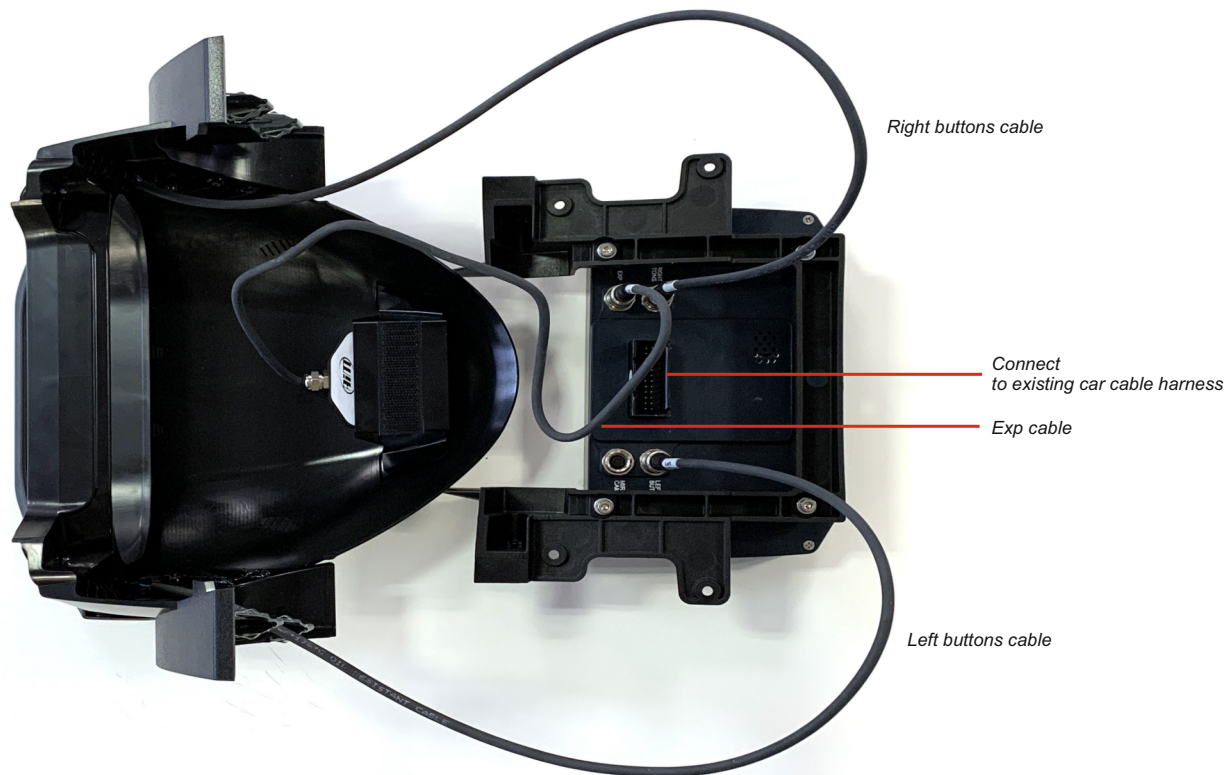

Install MX2E and AiM cluster.

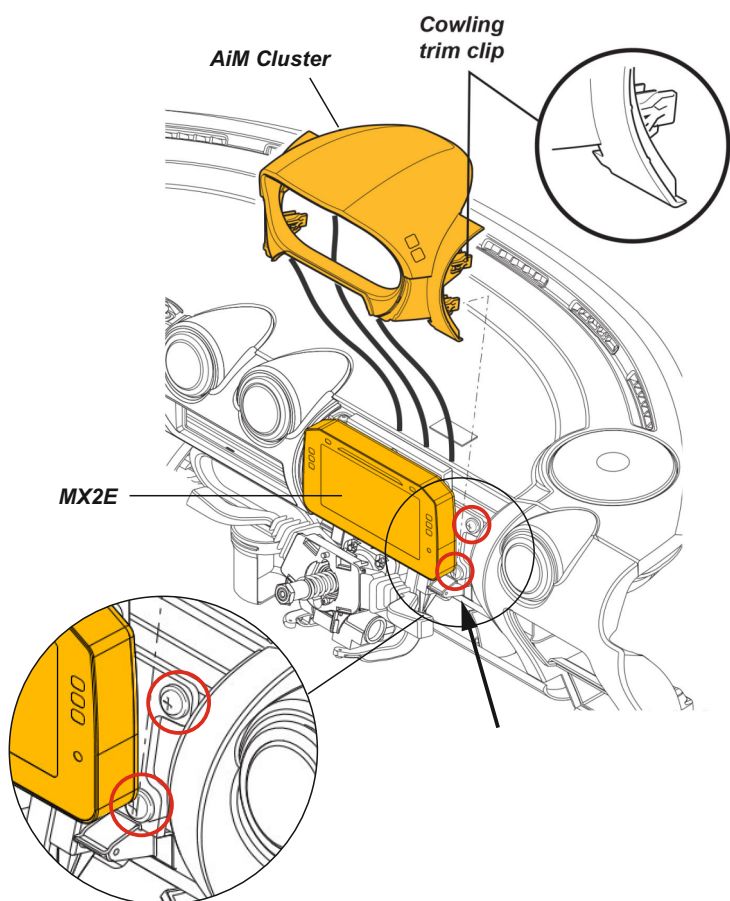

Re-install the original parts.

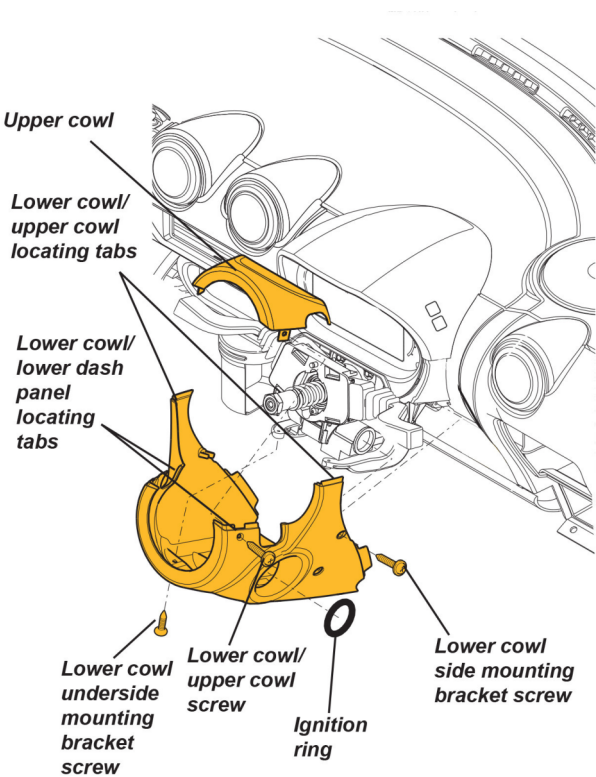

VISIT SUPPORT CENTER

SOFTWARE DOWNLOADS

FIRMWARE UPDATES

PRODUCT DOCUMENTATION

