

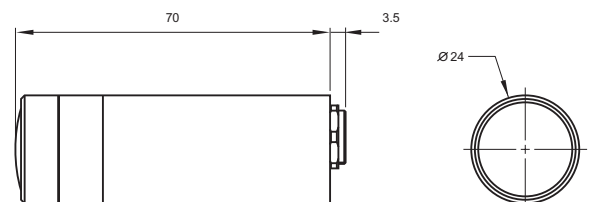

AiM SmartyCam GP HD Rev. 2.1

On-board camera with bullet cam

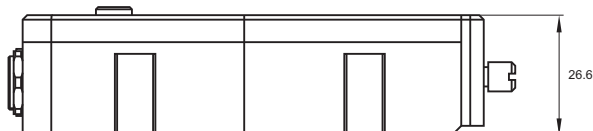

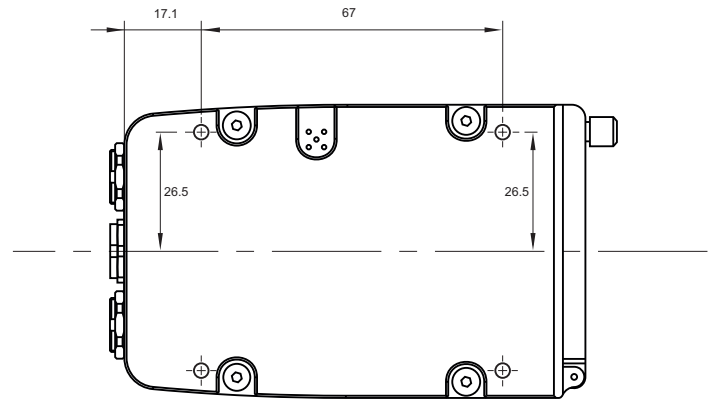
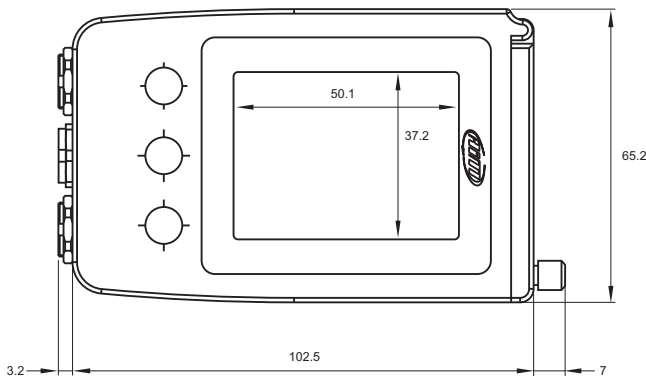

AiM SmartyCam GP HD Rev. 2.1

On-board camera with bullet cam

Technical characteristics

Video format	H.264 1280 x 720 pixels @ 30 fps
Display resolution	2.4" 240 x 320 pixels
Lens	Telecentric with 6 elements
Field of view	67° or 84°
Internal battery	Rechargeable lithium battery 1.040 mAh
Battery charge	700 mAh 12V
Internal battery duration	60 - 70 min of recording
External power	9-15 Volt
Supported SD card	Up to 128 GB
Memory capability	1.5 GB (1 hour low quality recording) 2 GB (1 hour medium quality recording) 4 GB (1 hour high quality recording)
Accelerometer	Three-axial $\pm 5G$
Usage temperatures	-10°C/+60°C
Auto Power ON	Yes, if connected to an AiM logger
Auto Power OFF	Yes
Auto Start/Stop Recording	Yes
Body	Anodized Aluminum
Dimensions	Main box 102.5 x 65.2 x 26.5 mm Bullet camera 24 diam x 73.5 mm
Bullet cable lenght	0.5 - 1.0 - 1.5 - 2.0 mt
Weight	Main unit 260 g Bullet 55 g
Waterproof	IP67



AiM SmartyCam GP HD Rev. 2.1

On-board camera with bullet cam

In the box

Bullet cam HFOV 67° lens

SmartyCam GP HD Rev. 2.1 recording module, bullet cam connection harness – L=2mt, Mini B – USB adapter cable, battery charger, 4Gb HC10 SD card, CD with software, user manual

X96SHG0267R21	With CAN harness – L = 2 mt
X96SHG0467R21	With CAN harness – L = 4 mt
X96SHG0167R21	With External power harness – L = 2 mt

Bullet cam HFOV 84° lens

SmartyCam GP HD Rev. 2.1 recording module, bullet cam connection harness – L=2mt, Mini B – USB adapter cable, battery charger, 4Gb HC10 SD card, CD with software, user manual

X96SHG0284R21	With CAN harness – L = 2 mt
X96SHG0484R21	With CAN harness – L = 4 mt
X96SHG0184R21	With External power harness – L = 2 mt

Spare parts

X90TMPC002	USB cable
V02566070	CAN harness - L = 2 mt
V02566060	CAN harness - L = 4 mt
V02566150	External power harness - L=2 mt
V02566390	Bullet cam connection harness - L=0.5 mt
V02566480	Bullet cam connection harness - L=1 mt
V02566470	Bullet cam connection harness - L=1.5 mt
V02566590	Bullet cam connection harness - L=2 mt
XSMGPBCHD67	Bullet cam SmartyCam GP HD 67°
XSMGPBCHD84	Bullet cam SmartyCam GP HD 84°
X96KVBGPHD6	Glass replacement kit bullet cam SmartyCam GP HD 67°
X96KVBGPHD84	Glass replacement kit bullet cam SmartyCam GP HD 84°

Accessories

X40GPS8SHD20	GPS08 Module for SmartyCam HD with 2 m lenght cable
X40GPS8SHD40	GPS08 Module for SmartyCam HD with 4 m lenght cable
X40GPS8SHD2R	GPS08 Module for SmartyCam HD Roof version with 2 m lenght cable
X40GPS8SHD4R	GPS08 Module for SmartyCam HD Roof version with 4 m lenght cable



AiM SmartyCam GP HD Rev. 2.1

On-board camera with bullet cam

Cable + external microphone

V02566080	External power + Integrated external microphone harness L=2 mt
V02566230	External power + Integrated external microphone harness L=4 mt
V02566310	External power + Integrated 3.5 female Jack for external microphone harness - L = 2 mt
V02566320	External power + Integrated 3.5 female Jack for external microphone harness - L = 4 mt
V02566100	CAN Bus + Integrated external microphone harness - L = 2 mt
V02566240	CAN Bus + Integrated external microphone harness - L = 4 mt
V02566290	CAN Bus + Integrated 3.5 female Jack for external microphone harness - L = 2 mt
V02566300	CAN Bus + Integrated 3.5 female Jack for external microphone harness - L = 4 mt

Record unit bracket kits

X90KSGPRB	Roll-bar kit In the box: handlebar bracket, 90 mm arm, clamp base with ball, mounting bracket, locknuts, washers and screws
X90KSGPTP	U-bolt kit In the box: U-bolt, 90 mm arm, clamp base with ball, mounting bracket, locknuts, washers and screws
X90KSGPVS	Suction cup In the box: suction cup, 90 mm arm, clamp base with ball, locknuts, washers and screws

Bullet cam bracket kits

X90KSBLRB	Roll-bar kit In the box: handlebar bracket, 60 mm arm, ball head, bullet-cam bracket
X90KSBLTP	U-bolt kit In the box: U-bolt, 60 mm arm, ball head, bullet-cam bracket
X90KSBLV0	Suction cup In the box: suction cup, 60 mm arm, ball head, bullet-cam bracket



AiM SmartyCam GP HD Rev. 2.1

On-board camera with bullet cam

Pinout

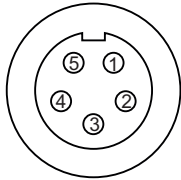
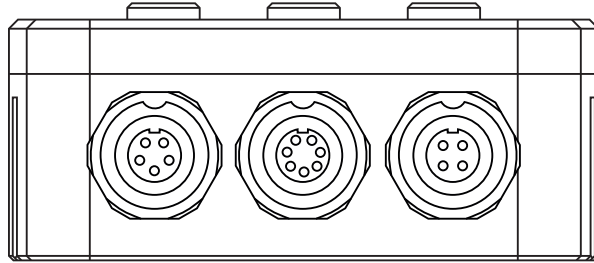

5 pins Binder 712
female connector pinout
external view (camera)

- 1 - LVDS+
- 2 - GND
- 3 - Bullet +Vb
- 4 - Serial I/O
- 5 - LVDS-

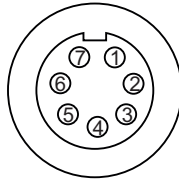

7 pins Binder 712
female connector pinout
external view (Ext)

- 1 - CAN+
- 2 - GND
- 3 - +Vb
- 4 - CAN-
- 5 - +Vbext
- 6 - GND
- 7 - Mic+

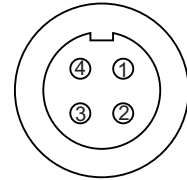

4 pins Binder 712
female connector pinout
external view (GPS)

- 1 - CAN+
- 2 - GND
- 3 - +Vb
- 4 - CAN-



AiM SmartyCam GP HD Rev. 2.1

On-board camera with bullet cam

Product history

Rel	From serial number	Date	Changes
Rel00	4102355	Mar, 10th 2016	<ul style="list-style-type: none">▪ SMC-06C: Main board New position of internal microphone with holes in lower mechanical box to improve audio recording▪ Rear mechanical box: new drawing with holes and place for install internal microphone